

- NOTES**
- *AS BUILT INFORMATION AS PER VERNON-NAGEL FOREMAN
 - ROOF DRAINS, FOUNDATION DRAINS, & OTHER CLEAN WATER CONNECTIONS TO THE SANITARY SEWER ARE PROHIBITED.
 - 18' VERTICAL & 10' HORIZONTAL SEPARATION SHALL BE MAINTAINED BETWEEN WATER LINE & SANITARY SEWER.
 - T/C 0.10' BELOW @ STREET GRADES SHOWN ARE @ ELEV.
 - SEED & MULCH RIGHT-OF-WAY & BACK LOT SWALES.
 - PROVIDE EROSION CONTROL AT BACK LOT CATCH BASINS, AT STORM MANHOLE WITH CATCH BASIN TOP AT BROADMOOR & EXISTING CATCH BASIN AT BRIARHEATH & CLAIRMONT.
 - WATER LINE IS TO BE BELOW STORM TAPS.

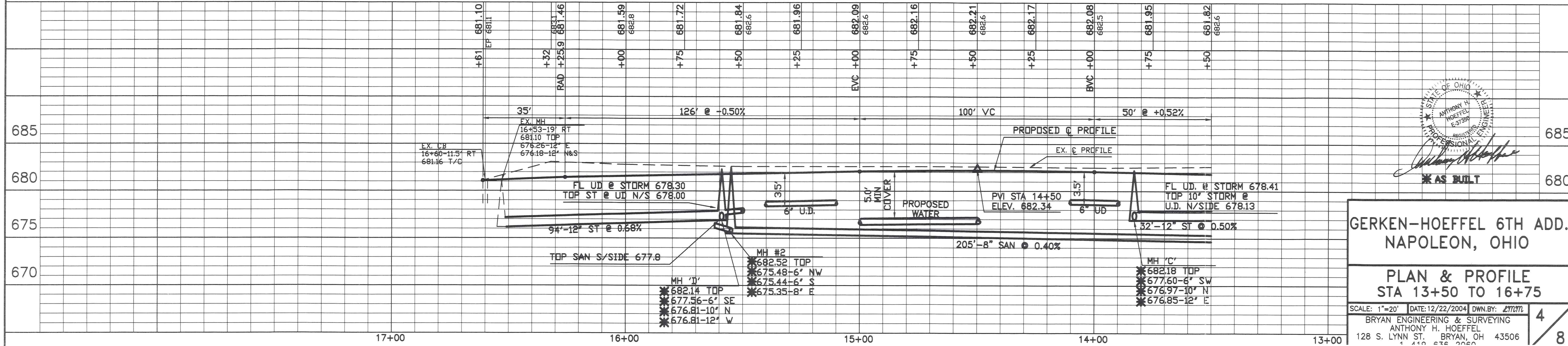

STATE OF OHIO
 ANTHONY H. HOEFFEL
 E-3738
 PROFESSIONAL SURVEYOR
 AS BUILT

GERKEN-HOEFFEL 6TH ADD.
 NAPOLEON, OHIO

PLAN & PROFILE
 STA 13+50 TO 16+75

SCALE: 1"=20' DATE: 12/22/2004 DWN BY: ETT/DTL
 BRYAN ENGINEERING & SURVEYING
 ANTHONY H. HOEFFEL
 128 S. LYNN ST. BRYAN, OH 43506
 4
 8